

STATE HIGHWAY 164

COUNTY HIGHWAY K

EXECUTIVE DRIVE

Sussex Gateway Retail Center

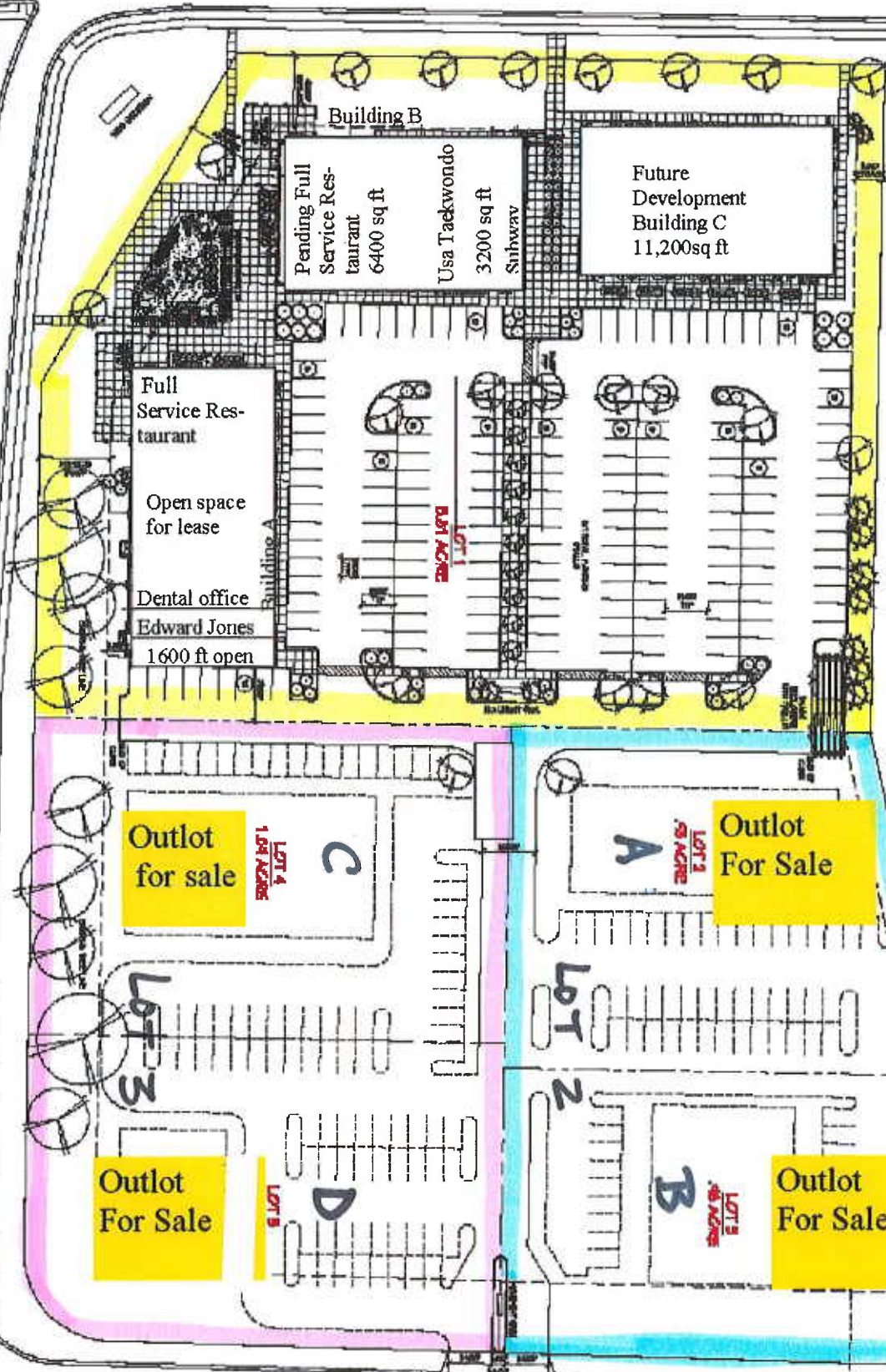

THE FINAL DEVELOPMENT SHALL BE SUBJECT TO THE APPROVAL OF THE LOCAL GOVERNMENT AND THE STATE DEPARTMENT OF TRANSPORTATION. THE DEVELOPER SHALL BE RESPONSIBLE FOR OBTAINING ALL NECESSARY PERMITS AND APPROVALS. THE DEVELOPER SHALL BE RESPONSIBLE FOR THE DESIGN AND CONSTRUCTION OF ALL UTILITIES AND INFRASTRUCTURE. THE DEVELOPER SHALL BE RESPONSIBLE FOR THE DESIGN AND CONSTRUCTION OF ALL PAVING AND CURBS. THE DEVELOPER SHALL BE RESPONSIBLE FOR THE DESIGN AND CONSTRUCTION OF ALL LIGHTING AND SIGNAGE. THE DEVELOPER SHALL BE RESPONSIBLE FOR THE DESIGN AND CONSTRUCTION OF ALL LANDSCAPING AND PLANTING. THE DEVELOPER SHALL BE RESPONSIBLE FOR THE DESIGN AND CONSTRUCTION OF ALL FENCE AND SECURITY SYSTEMS. THE DEVELOPER SHALL BE RESPONSIBLE FOR THE DESIGN AND CONSTRUCTION OF ALL PARKING AND TRAFFIC CONTROL MEASURES. THE DEVELOPER SHALL BE RESPONSIBLE FOR THE DESIGN AND CONSTRUCTION OF ALL UTILITIES AND INFRASTRUCTURE. THE DEVELOPER SHALL BE RESPONSIBLE FOR THE DESIGN AND CONSTRUCTION OF ALL PAVING AND CURBS. THE DEVELOPER SHALL BE RESPONSIBLE FOR THE DESIGN AND CONSTRUCTION OF ALL LIGHTING AND SIGNAGE. THE DEVELOPER SHALL BE RESPONSIBLE FOR THE DESIGN AND CONSTRUCTION OF ALL LANDSCAPING AND PLANTING. THE DEVELOPER SHALL BE RESPONSIBLE FOR THE DESIGN AND CONSTRUCTION OF ALL FENCE AND SECURITY SYSTEMS. THE DEVELOPER SHALL BE RESPONSIBLE FOR THE DESIGN AND CONSTRUCTION OF ALL PARKING AND TRAFFIC CONTROL MEASURES.

THE DEVELOPER SHALL BE RESPONSIBLE FOR THE DESIGN AND CONSTRUCTION OF ALL UTILITIES AND INFRASTRUCTURE. THE DEVELOPER SHALL BE RESPONSIBLE FOR THE DESIGN AND CONSTRUCTION OF ALL PAVING AND CURBS. THE DEVELOPER SHALL BE RESPONSIBLE FOR THE DESIGN AND CONSTRUCTION OF ALL LIGHTING AND SIGNAGE. THE DEVELOPER SHALL BE RESPONSIBLE FOR THE DESIGN AND CONSTRUCTION OF ALL LANDSCAPING AND PLANTING. THE DEVELOPER SHALL BE RESPONSIBLE FOR THE DESIGN AND CONSTRUCTION OF ALL FENCE AND SECURITY SYSTEMS. THE DEVELOPER SHALL BE RESPONSIBLE FOR THE DESIGN AND CONSTRUCTION OF ALL PARKING AND TRAFFIC CONTROL MEASURES. THE DEVELOPER SHALL BE RESPONSIBLE FOR THE DESIGN AND CONSTRUCTION OF ALL UTILITIES AND INFRASTRUCTURE. THE DEVELOPER SHALL BE RESPONSIBLE FOR THE DESIGN AND CONSTRUCTION OF ALL PAVING AND CURBS. THE DEVELOPER SHALL BE RESPONSIBLE FOR THE DESIGN AND CONSTRUCTION OF ALL LIGHTING AND SIGNAGE. THE DEVELOPER SHALL BE RESPONSIBLE FOR THE DESIGN AND CONSTRUCTION OF ALL LANDSCAPING AND PLANTING. THE DEVELOPER SHALL BE RESPONSIBLE FOR THE DESIGN AND CONSTRUCTION OF ALL FENCE AND SECURITY SYSTEMS. THE DEVELOPER SHALL BE RESPONSIBLE FOR THE DESIGN AND CONSTRUCTION OF ALL PARKING AND TRAFFIC CONTROL MEASURES.

