

S30 W37372 School Section Lake Road Town of Ottawa ~ Waukesha County

**NEW
PRICE**

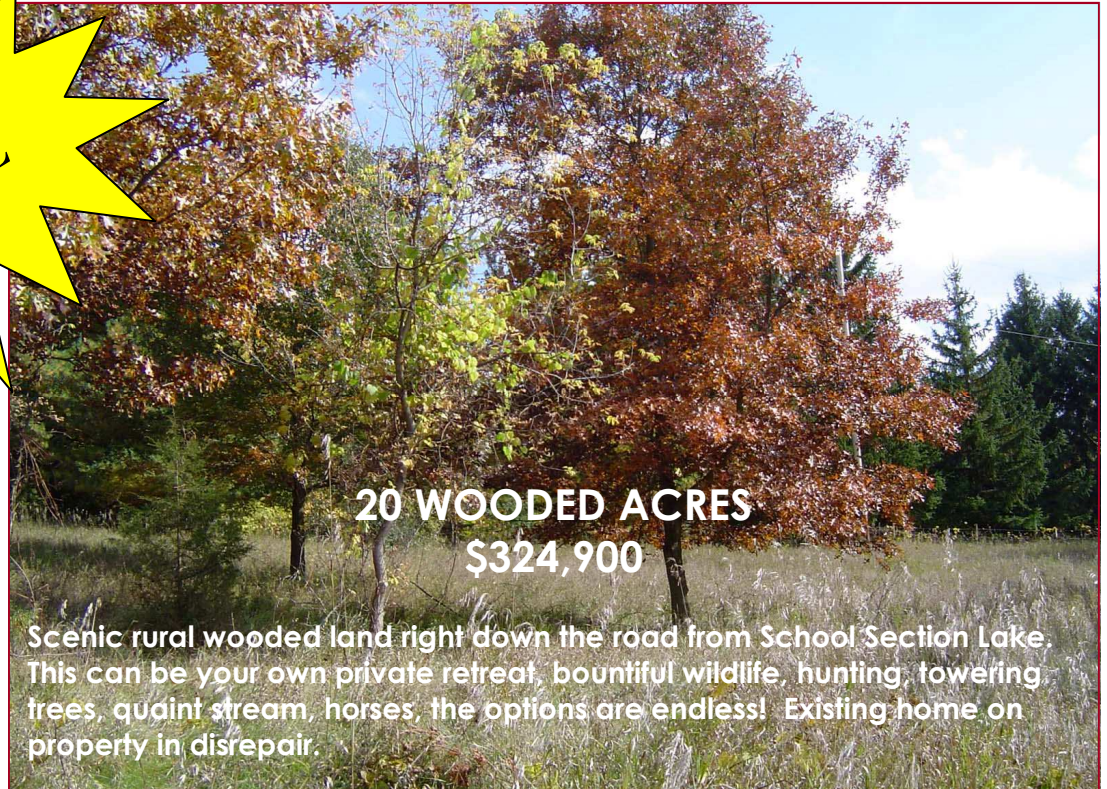

20 WOODED ACRES
\$324,900

Scenic rural wooded land right down the road from School Section Lake. This can be your own private retreat, bountiful wildlife, hunting, towering trees, quaint stream, horses, the options are endless! Existing home on property in disrepair.

Utilities		Tax Information	
Telephone/ Cable	Yes Telephone No Cable	Tax Key	OTWT1620998
Electric/Gas	Yes Electric No Natural Gas	Tax Amount / Year	\$3,034.08 / 2009
Water	Private Well on-site (condition "as-is")	Association Dues:	None
Waste	Septic on-site (condition "as-is")	Zoned	8 Acres—Residential 12 Acres—Managed Forest

School District	Kettle Moraine School District
Pin # / MLS#	PIN# 1664 / MLS# 1114278
Listing Agent	Bill Minett

Directions: I-94 exit Hwy. 67 south, to Cty. D west. Continue straight onto School Section Lake Road (Cty. D splits off to the left) to property on right.



www.billminett.com

426 E. Wisconsin Avenue
Oconomowoc, WI 53066

Toll free: 1-877-367-6480
Fax: 262-567-6640